



Fabweld Steel Products Ltd

Going Beyond Expectations

## FAB GRAB S10 Installation Guide



Figure 1

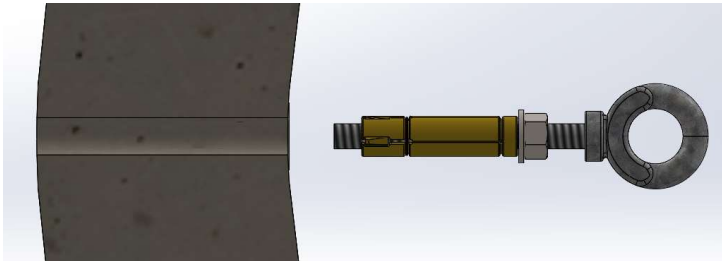

Figure 2

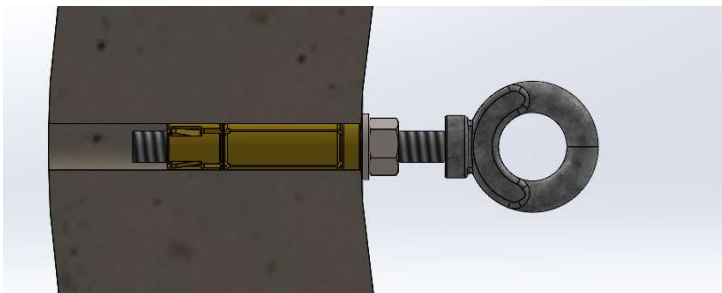

Figure 3

1. Drill Holes for anchors in position detailed in Figure 4. Using an 16mm masonry bit drill to at least 80mm depth in positions as illustrated below

2. Remove debris from holes and insert shield anchors complete with eyebolt, nut, washer & chain attached on right hand side

3. Tighten nut to a suitable level of torque with approximately 15mm of exposed thread past the nut on each side, adjust eye bolt (and tighten nut) if required to meet  $\frac{1}{4}D$  dimension shown below in Figure 4.

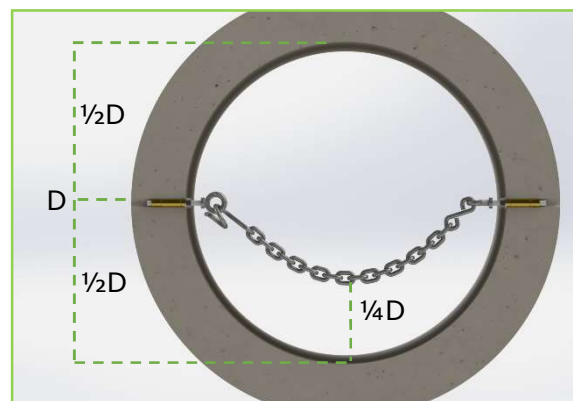

Figure 4

The above image shows the chain in the 'in-service' position. To connect the pig tail link to the eye bolt insert and rotate through 180°. To apply the 'out-of-service' position hook the left hand pig tail link on to the right hand eye bolt.

For more information contact our sales team on **01952 581430** or **[sales@fsp.co.uk](mailto:sales@fsp.co.uk)**